

Notes on Chicago Installations:

- Must be field wired under authority of a permit by a contractor licensed in the city of Chicago.
- Harnesses and quick connect connectors not allowed in the city of Chicago.
- UL listed under File 2R75.

NOTE: For Answer panels manufactured prior to October 2011, see assembly direction 939504600.

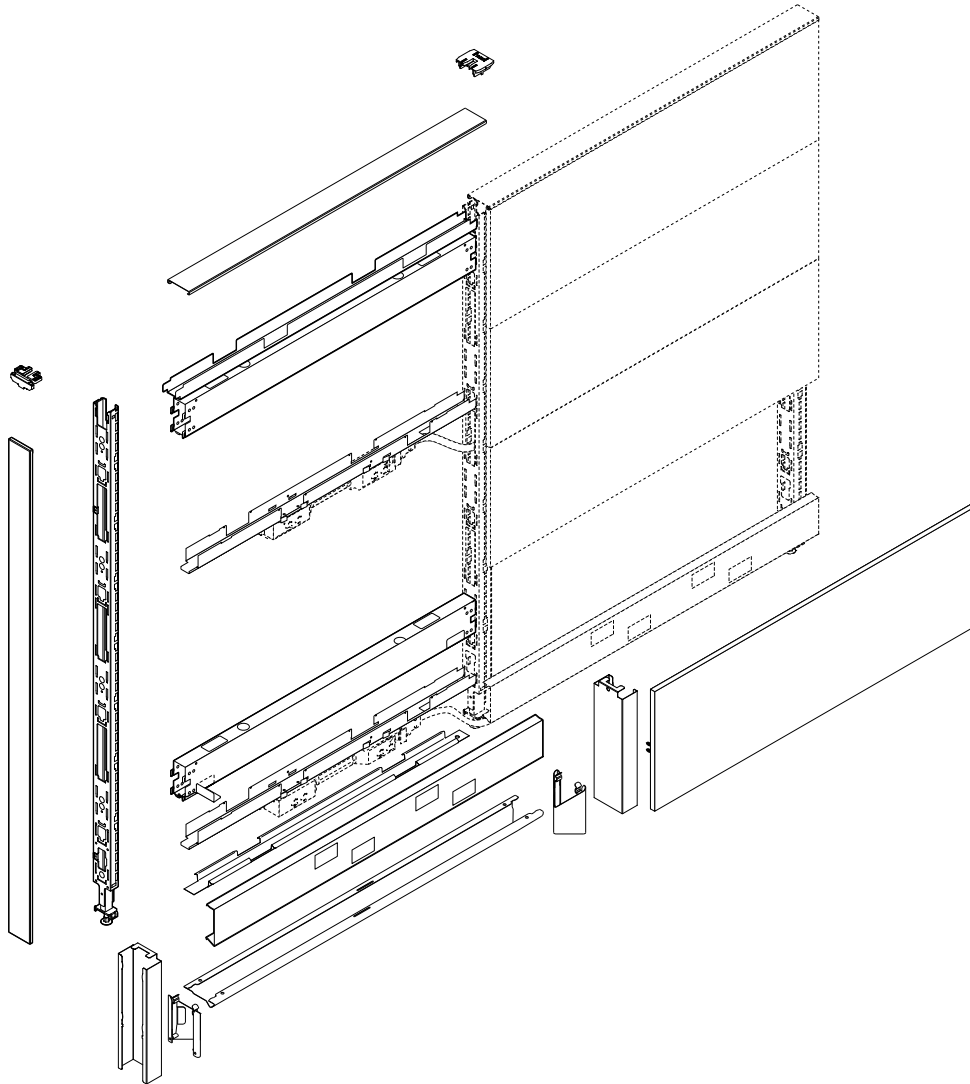

If you have a problem, question, or request, call your local dealer, or Steelcase Line 1 at **888.STEELCASE** (888.783.3522) for immediate action by people who want to help you. (Outside the U.S.A., Canada, Mexico, Puerto Rico, and the U.S. Virgin Islands, call: 1.616.247.2500) Or visit our website: www.steelcase.com

© 2014 Steelcase Inc.
Grand Rapids, MI 49501
U.S.A.

Printed in U.S.A.

⚠ WARNING



Risk of Fire or Electric Shock

- All electrical installations should be performed by a qualified person in accordance with codes and regulations applicable at the installation site. Circuits should be checked for proper voltages. All sources of power supply must be disconnected prior to any servicing or installation.

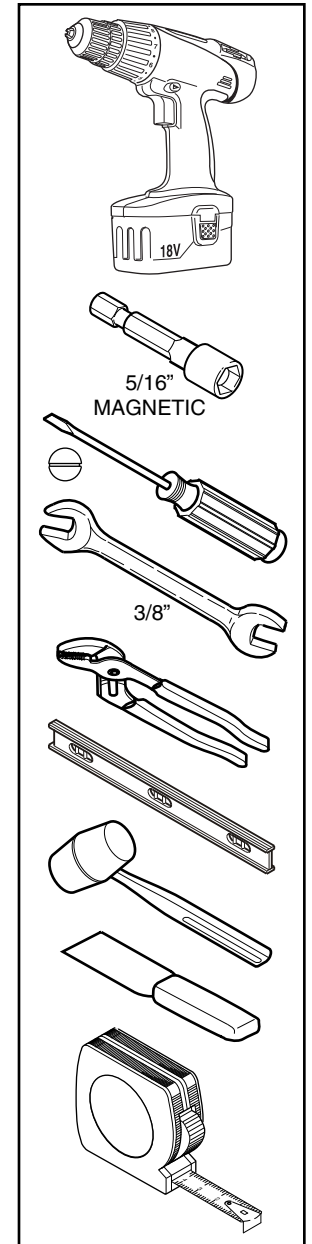

Glossary of Parts

- A - Wall Start
- B - EOR Vertical Junction
- C - Inline Vertical Junction
- D - "L" Vertical Junction
- E - "T" Vertical Junction
- F - "X" Vertical Junction
- G - 120° "V" Vertical Junction
- H - 120° "Y" Vertical Junction
- I - Horizontal Beam
- J - Cable Tray
- K - Power Kit
- L - Base Covers
- M - Cable Channel
- N - Skin
- O - Junction Caps
- P - Top Trim
- Q - Vertical Trim
- R - Junction Blocks
- S - Corner Light Seal
- T - Trim Aligners
- U - Modular Receptacle
- V - Modular Power Bezel
- W - Filler Covers (Data & Power)

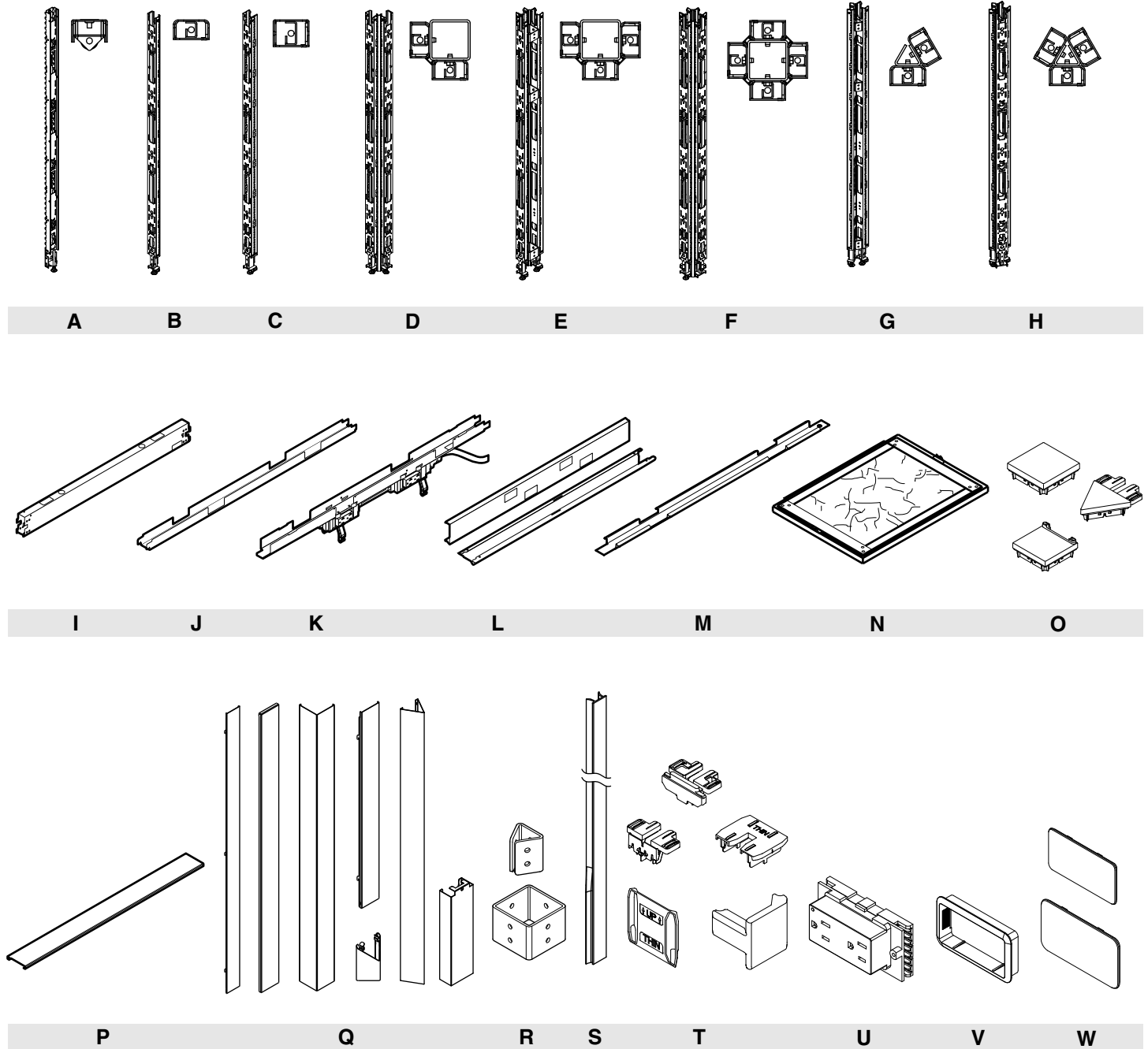

PHASE 1 - Vertical Junctions and Horizontal Bars

1. Inventory and stage all vertical junctions and horizontal bars.

2. Reconfigure junctions if opposite hands are needed for 'L' and 'V' change-of-height applications. Remove junction block screws from one junction (2a). Re-install junction block on opposite face of junction blocks. Torque screws to 60-80 in-lbs (2b). Re-install corner light seal by flushing it with top of shorter junction. Insert seal legs into corner gap and apply thumb pressure along entire length until fully seated (2c).

TIP: Use of a cotton glove can aid light seal installation.

NOTE:

Horizontal bars should be connected to the lowest and highest positions possible in a panel run. For stability, always start in a corner when assembling frame components.

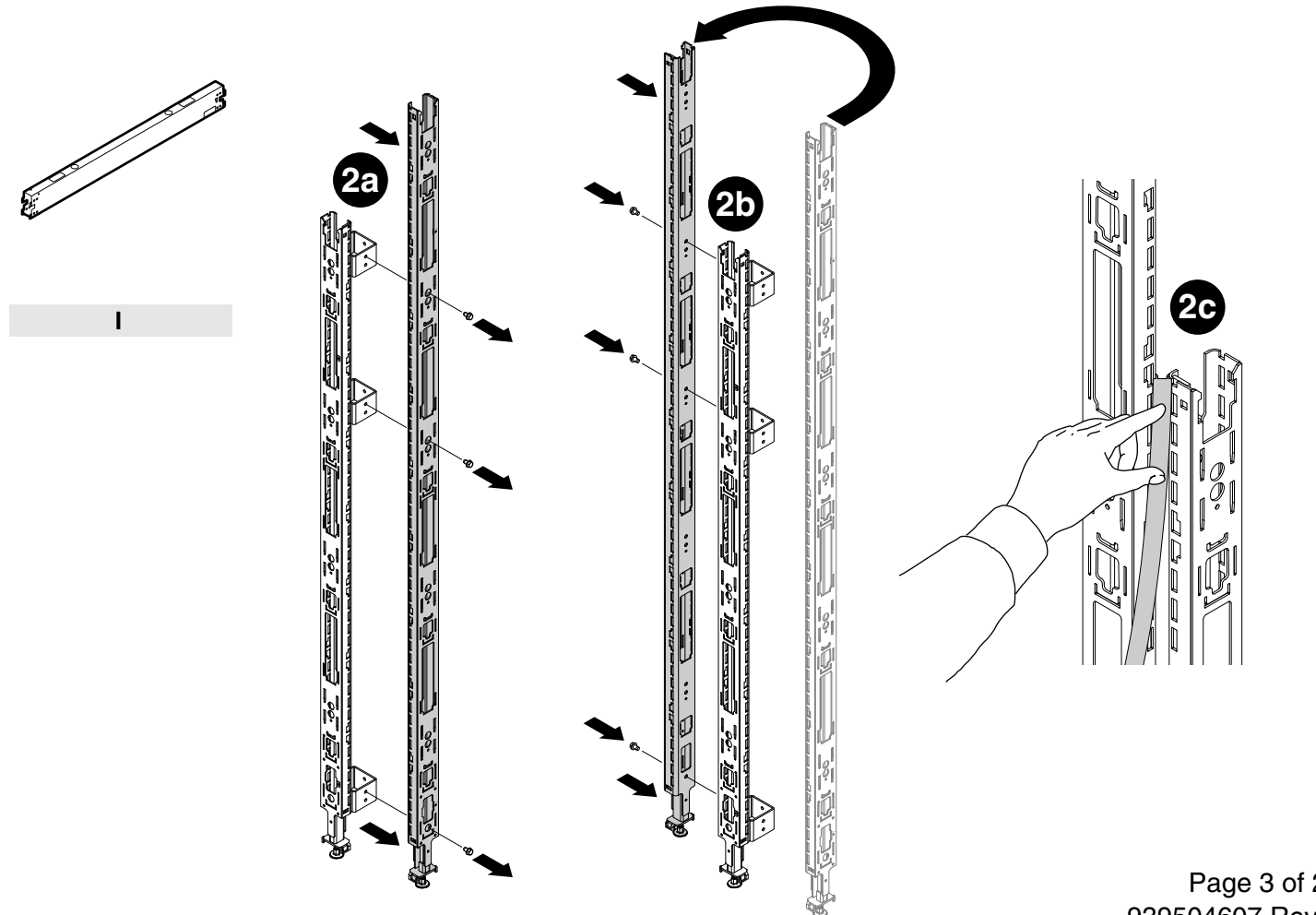
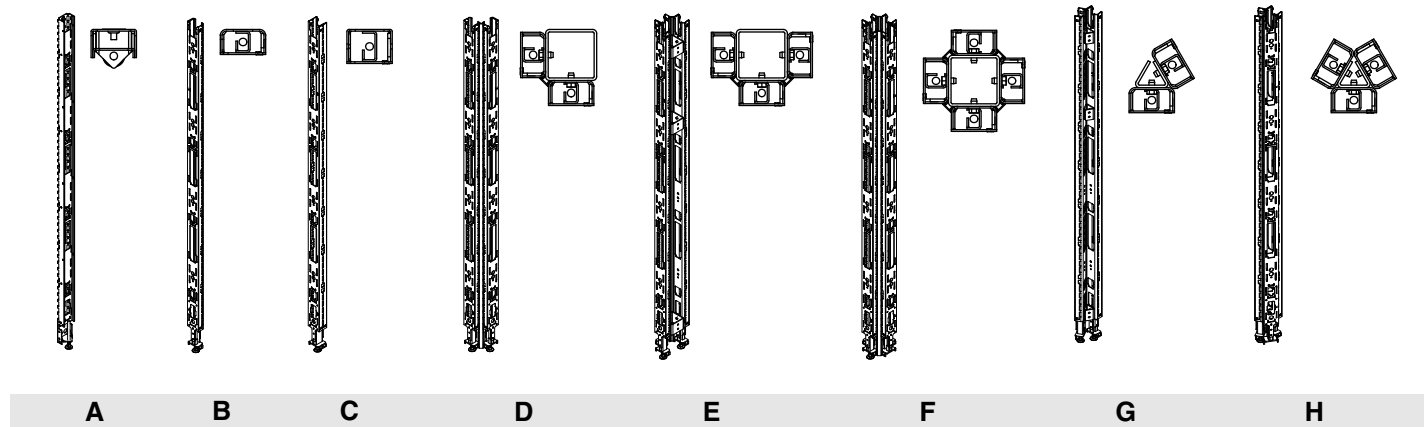

3. New junction configurations can be made in the field (e.g. converting an 'L' junction to a 'T' junction, or a 'T' junction into an 'X' junction), as long as the following "Junction Block Location Rules" are followed.

CAUTION:
Failure to use the proper number and location of junction blocks could result in personal injury.

JUNCTION BLOCK LOCATION RULES

NOTE: Rules apply for all 'L', 'T', 'X', 'V' & 'Y' junctions of equal and unequal heights.

Junction Size	'H' (inches)	Bottom Block	'A' (inches)	Top Block ¹
30	24-5/8	Yes	N/A	Yes
42	37	Yes	N/A	Yes
48	43-1/8	Yes	N/A if all equal height 32-1/2 if unequal height	Yes if all equal height N/A if unequal height
54	49-3/8	Yes	32-1/2	Yes
66	61-3/4	Yes	32-1/2	Yes
78	74-1/8	Yes	32-1/2	Yes

Yes = Block required

N/A = No block required

Top Block¹ = Always required when two or more junctions are present, except for 48 junction rule stated above.

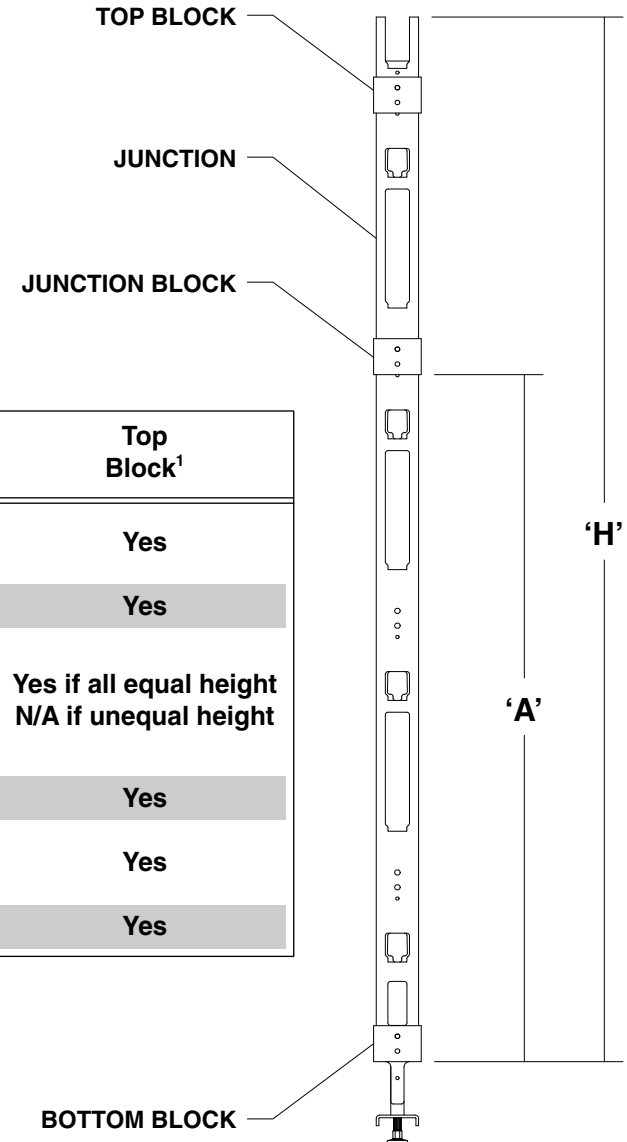

4. Lay out vertical junctions and horizontal bars close to their final installation position.

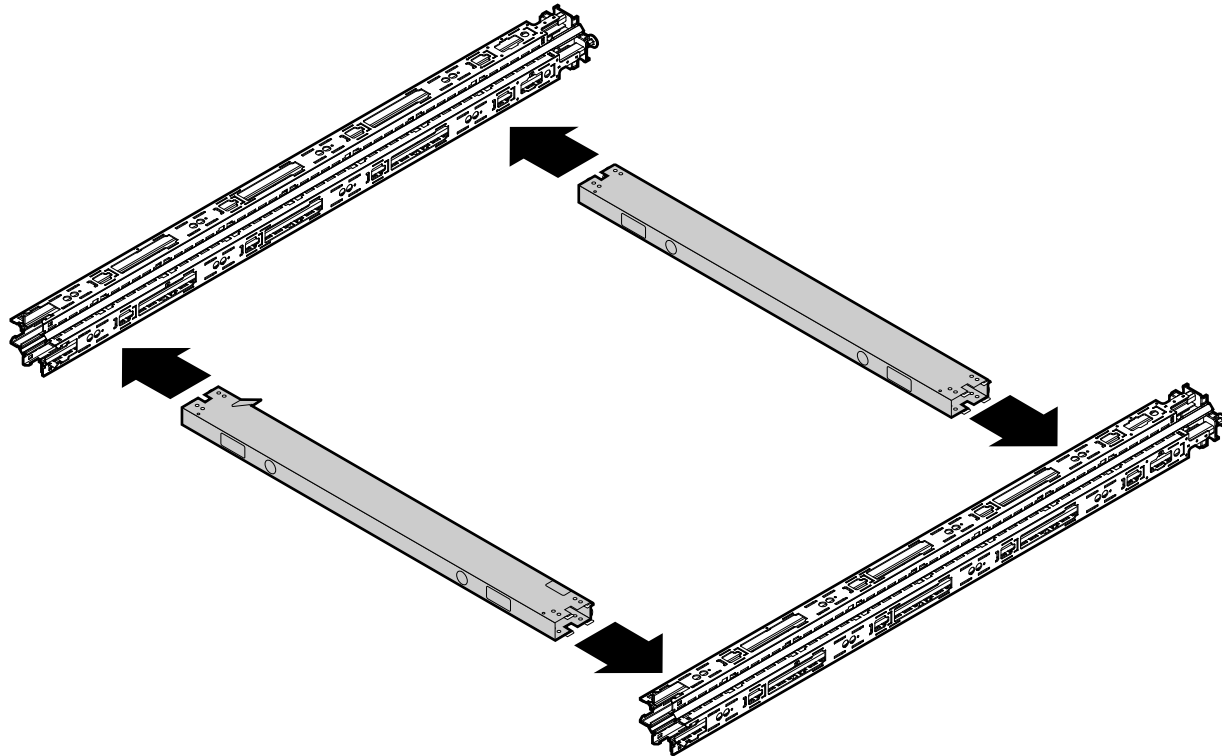

Special Case: Using Windows

Tip: Slatwall panels should be installed before windows.

If the window will be installed at the top position of the frame, the upper beam must be installed in a lower position, immediately below the window frame.

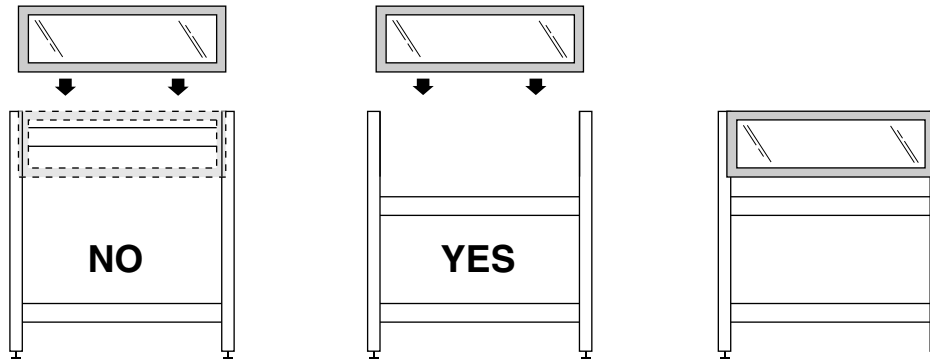

Non-Stacking

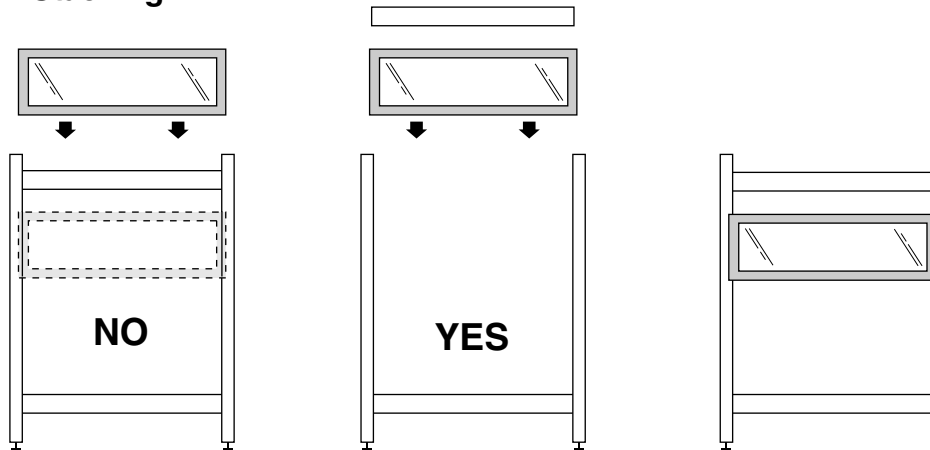

If the window is not being installed at the top of the frame, make sure you install your windows before installing any stacking junctions and beams above the window frames. **Remember that the base junctions must always be connected by two (2) beams!**

Stacking

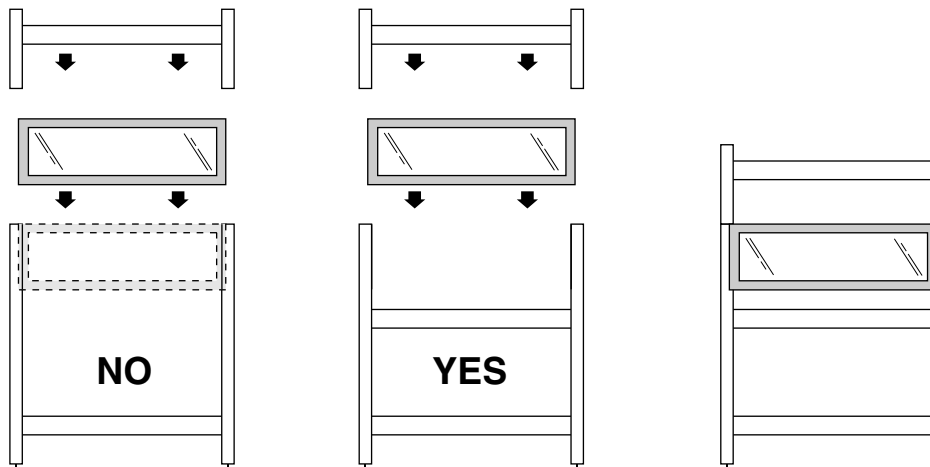

Refer to assembly direction 939501069 for window installation details.

- 5.** Open the quick lock. Insert the horizontal bar into the vertical junction. Tap into the vertical junction until the quick lock can be closed. **DO NOT USE THE MALLET TO CLOSE QUICK LOCK.**

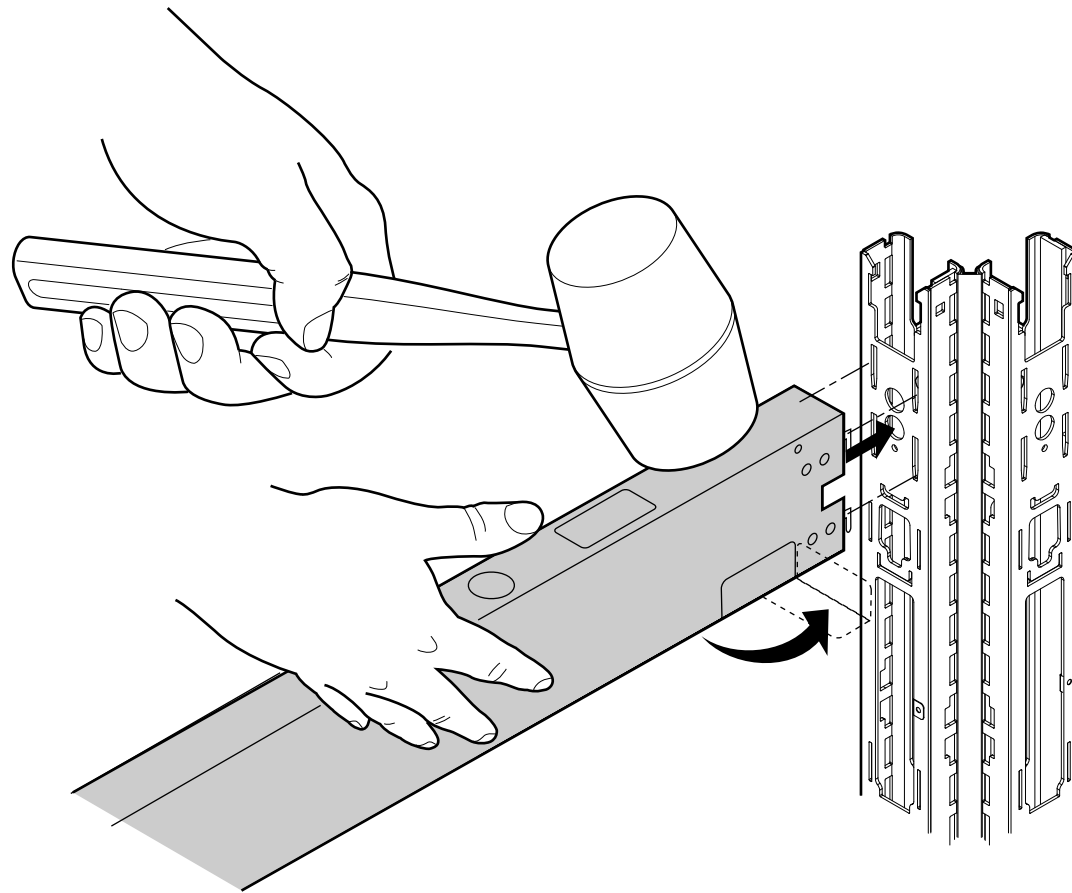

6. Attach a bar to the frame assembly on the floor, forming a corner. Raise the frame and corner assembly. Then assemble the next vertical junction in the panel run.

7. Entire system must be level and plumb before attaching skins. Level top of vertical junction to top of vertical junction.

NOTE: Install horizontal bars with quick locks locking on opposite sides.

8. To convert an 'L' or 'T' junction in the field, remove the 'L' or 'T' trim to expose existing blocks. Determine the proper block number and location for the new configuration using the Junction Block Location Rules on page 4. Remove any trims, components, skins or beams in order to meet the block requirements. Install or remove blocks as required per step 2a on page 3. Secure the new junction(s) to the blocks using one screw per block per step 2b on page 3. Torque screws to 60-80 in-lbs. Install the corner light seal per step 2c on page 3.

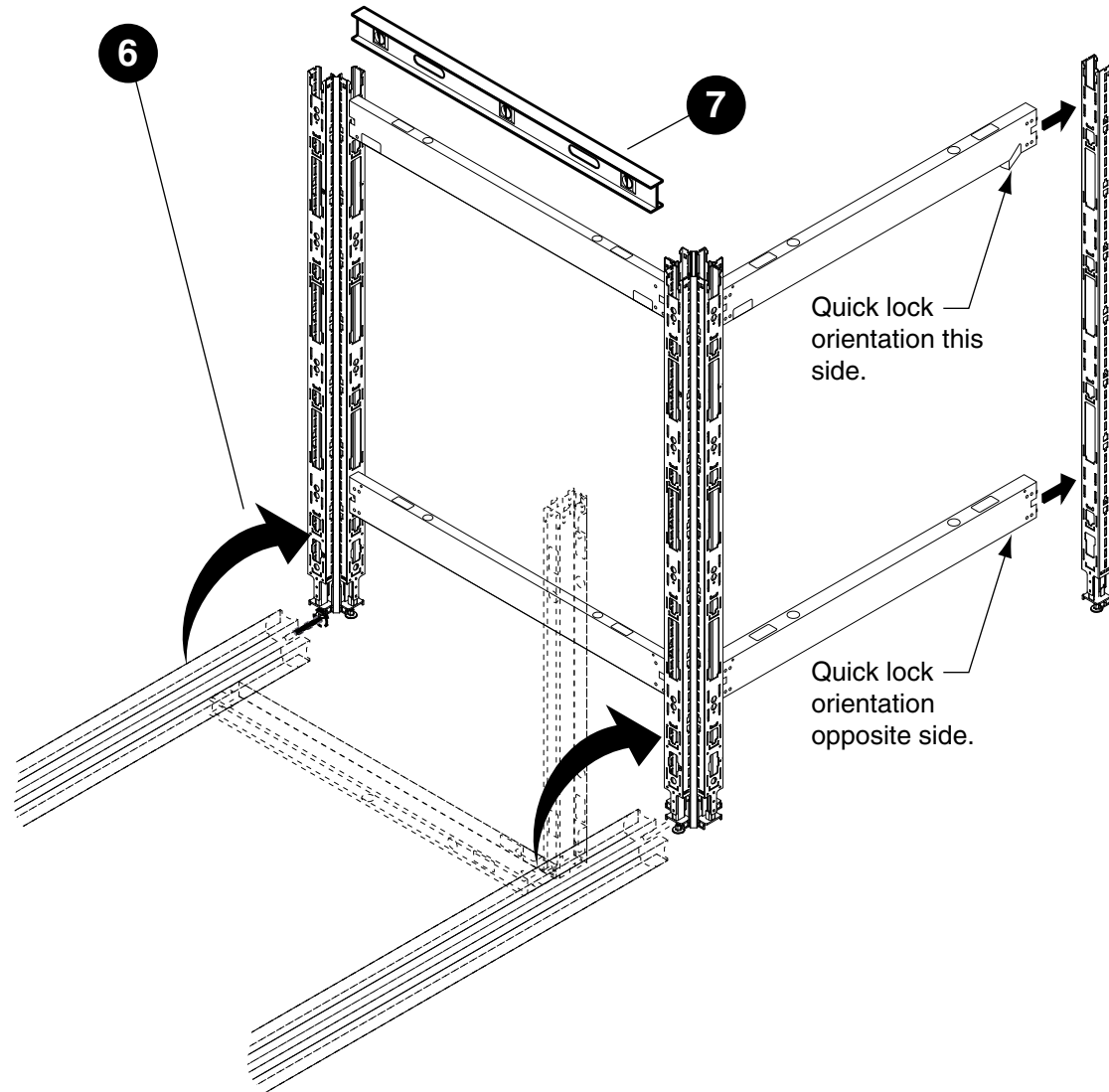

PHASE II - Power, Communications and Vertical Surfaces

1. Inventory and stage all cable trays, powerkits, base covers, and skins.

2. If cable tray was ordered, install where cables are being routed. If not being used for cable routing, install mid panel for extra rigidity behind skins. To install optional cable tray, slide end A into junction and then squeeze clip in end B. For 6" tech skins, the powerkit location must be adjusted via drop down bracket. Install drop down brackets into junctions at 'normal' powerkit location. Install powerkit into drop down brackets the same as you would into a junction. 6" steel skins can be installed at any 6" incremental location except in the bottom 12" of a junction. 6" tech skins can only be installed at the 30" elevation to align with the dropped down "normal" powerkit location.

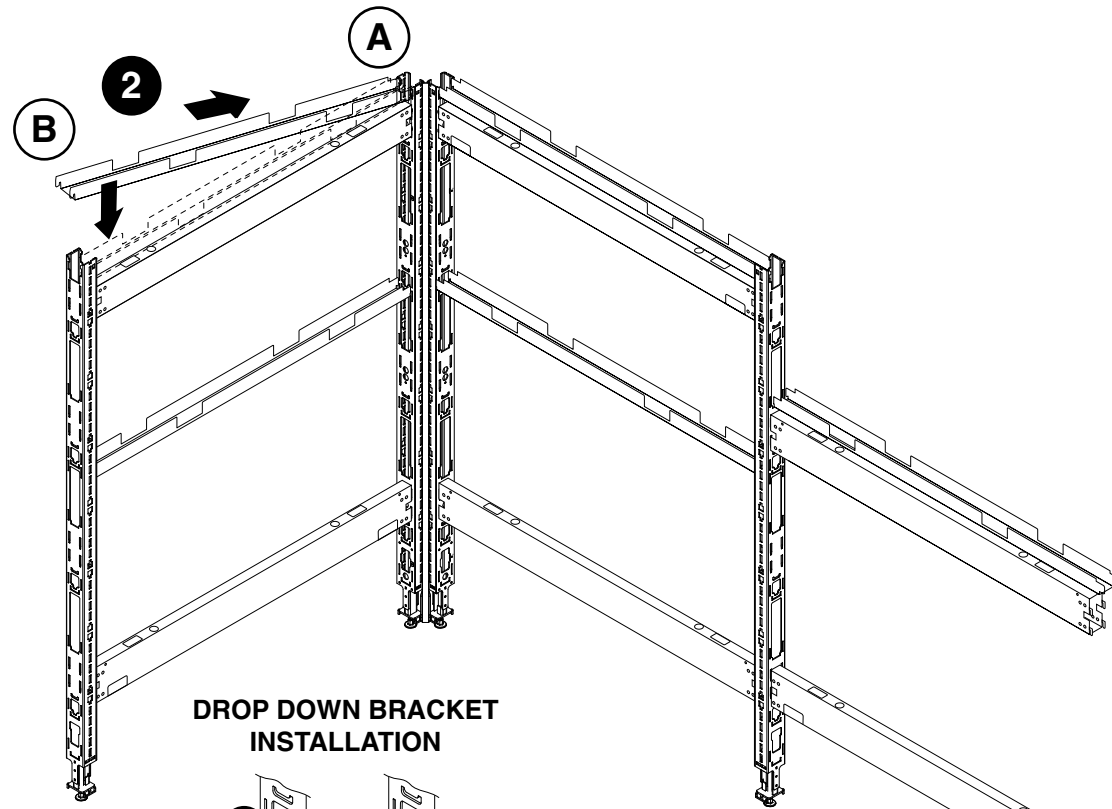
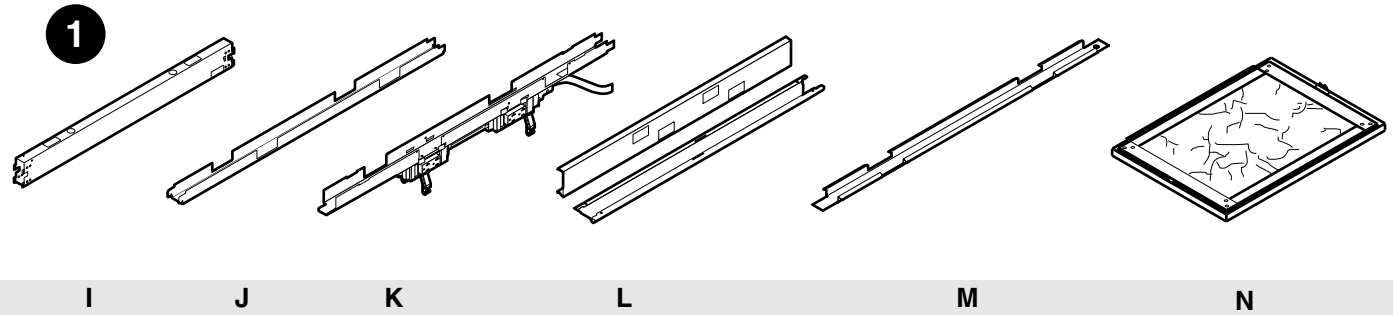

DROP DOWN BRACKET INSTALLATION

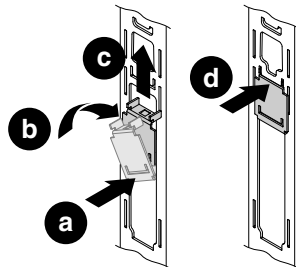

Twist to fit bottom of drop down bracket into junction. Straighten and push top of drop down bracket into junction slots.

3. Install power at the base or at any vertical increment of 12" within the frame. Chicago installation refer to P/N 939504634. For tech skins & covers refer to P/N 939504735. For all other installations refer to P/N 939504633.

4. Lay in communication cables at top and/or base. Feed them through at intermediate positions every 12" vertically.

INSTALLATION OF CABLE CHANNEL

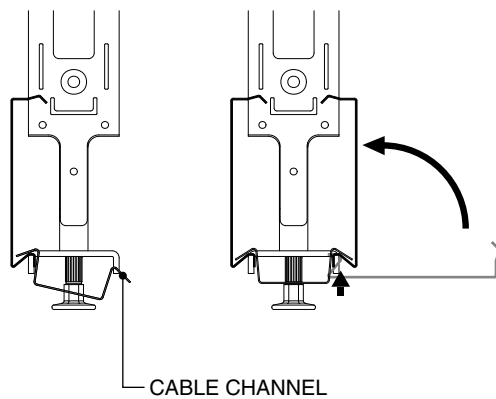

△ **Tip:**
To install Answer stacking in the future, leave slack in the wires in the top cable tray. A maximum of 10 wires in the top cut-out feature is recommended. Following these guidelines will help avoid relocating wires when adding Answer Stacking.

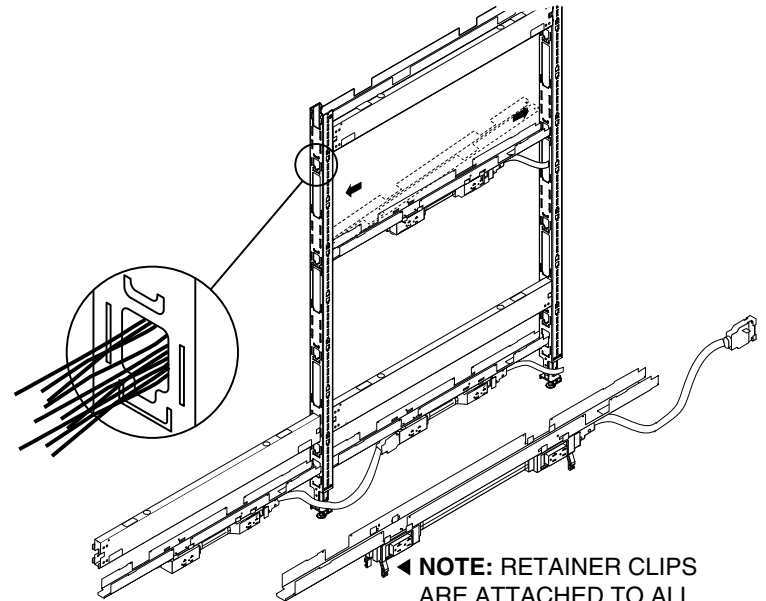

◀ **NOTE:** RETAINER CLIPS ARE ATTACHED TO ALL POWER KITS.

△ **Tip:**
Communications and power may be installed at 12" increments within a frame.

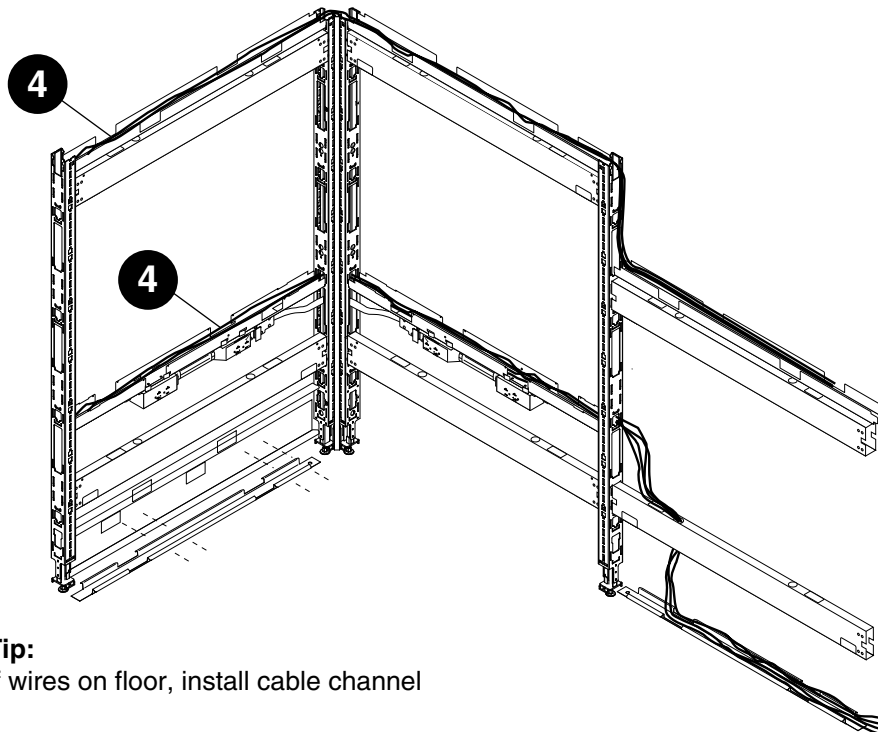

△ **Tip:**
If wires on floor, install cable channel

For Standard Base Trim

5. Install base cover by aligning hooks to slots at the bottom of the vertical junction. Support the cables at the base using cable bridges. Where receptacles will be placed, remove base cover knockouts as shown in figures (5a) and (5b).

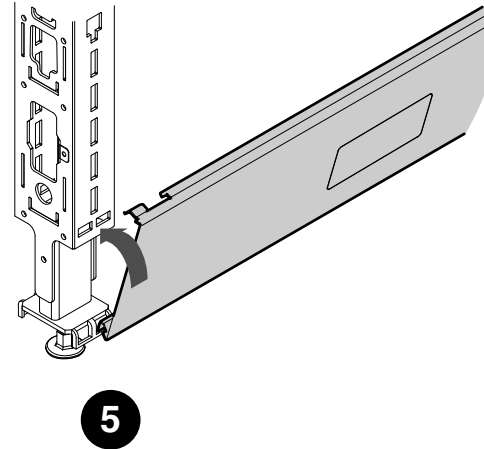

Base Cover Knockout

Remove knockout plate shown by striking from the front side of the base trim in indicated area with channel lock pliers.

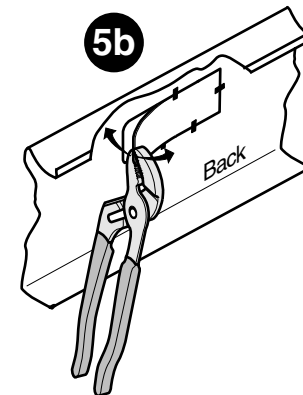
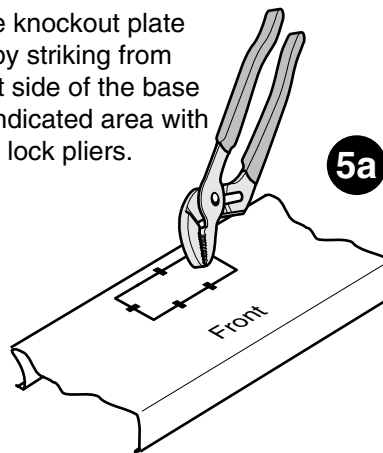

NOTE: If knockout plate does not fully disengage, grasp plate with pliers from back side and gently move back and forth to complete removal.

For Open Base Trim

5. Install open base cover by aligning tabs to slots at the bottom of the vertical junction (5c).

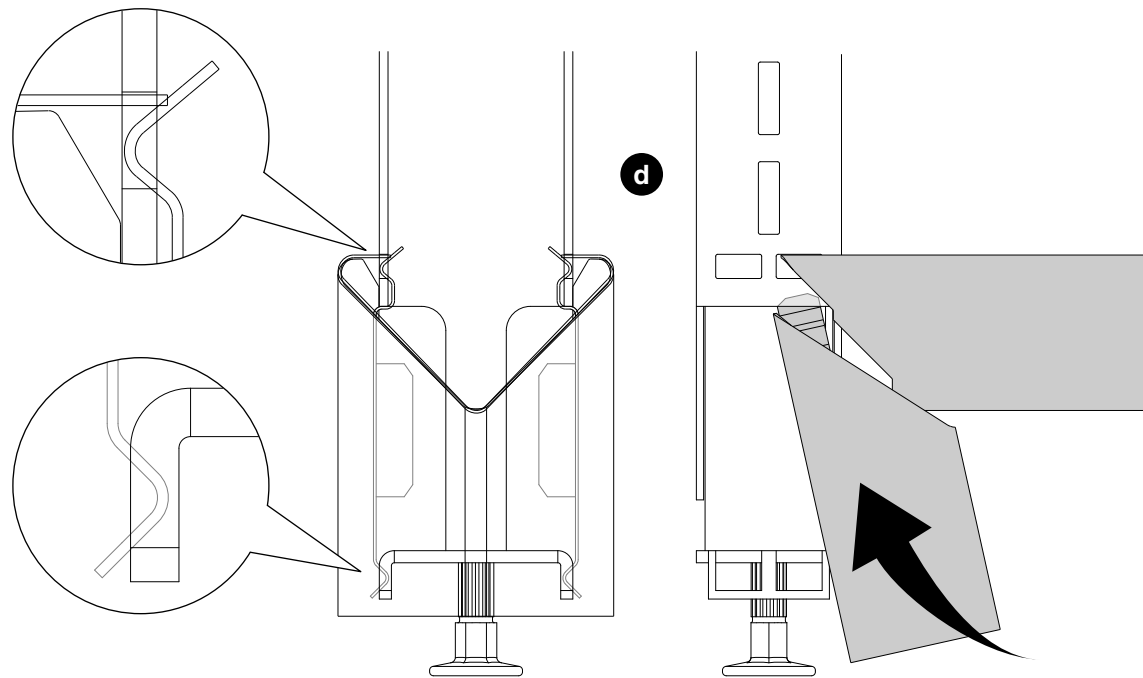
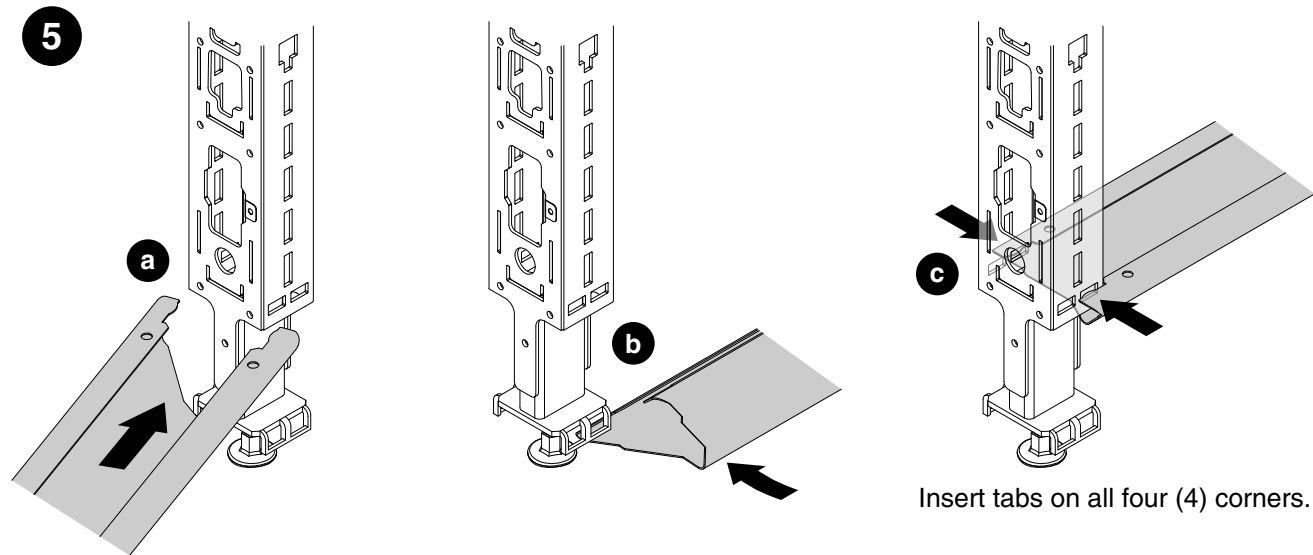

Insert clips on all four (4) corners.

For Big Open Base Trim

5. Install the big open base trim by flexing it over the vertical junction, aligning the four scallops (5a) to the vertical junction slots and to the square tabs (5b) with the base trim notches.

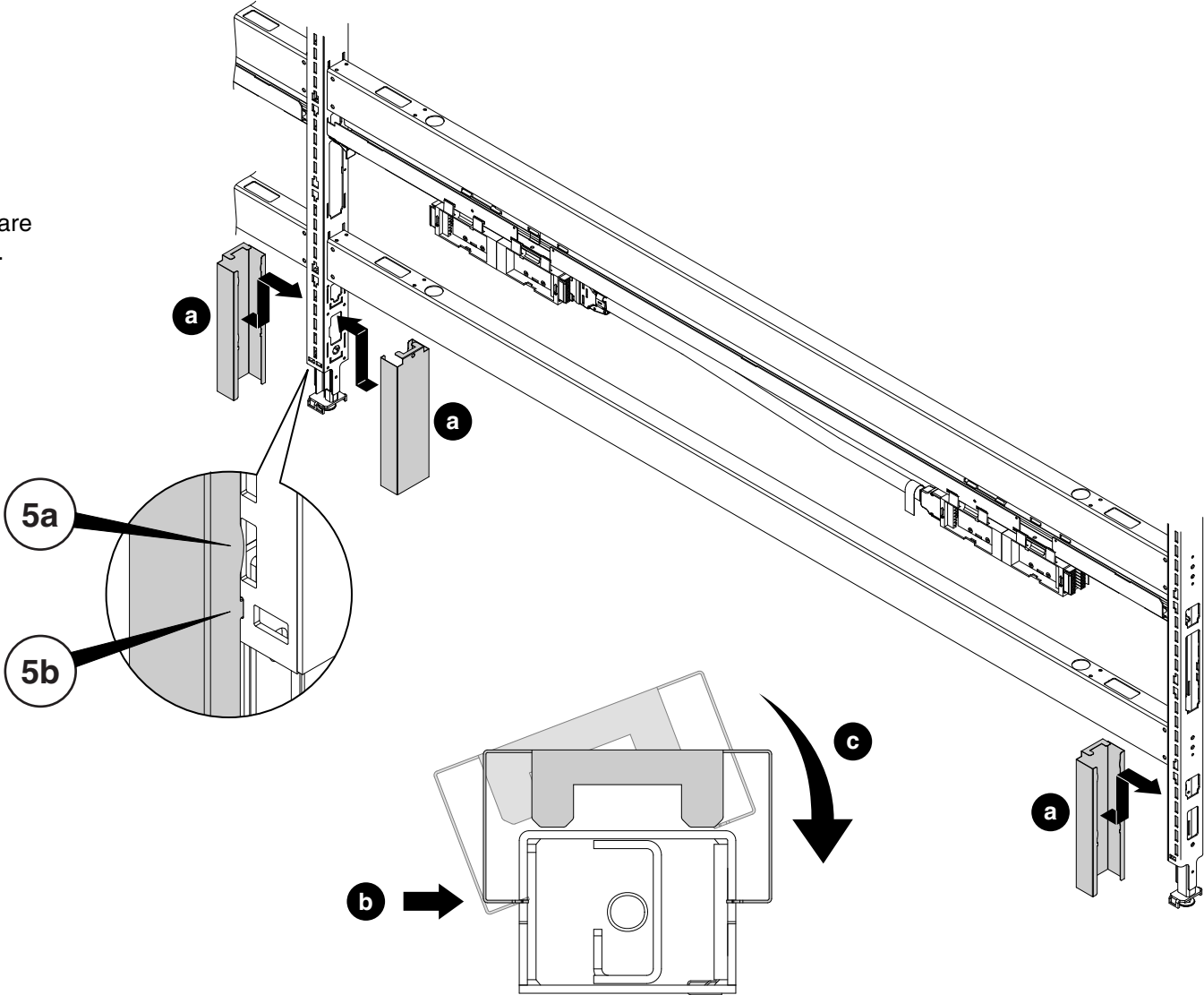

5. (continued)

To correct alignment and create uniform gaps between receptacle and base cover, adjust power block tab and power tray slot.

NOTE: Receptacles should stand out from the base cover. Align receptacles to base cover to fit. Be sure receptacles are properly installed. For Chicago installation refer to P/N 939504634. For all other installations refer to P/N 939504633.

NOTE: These instructions are to be used in conjunction with the appropriate electrical instructions. For Chicago installations use 939504634, for all other installations use 939504633.

NOTE: Open base trims **DO NOT** support base power-in, receptacles, or off-module panel connection.

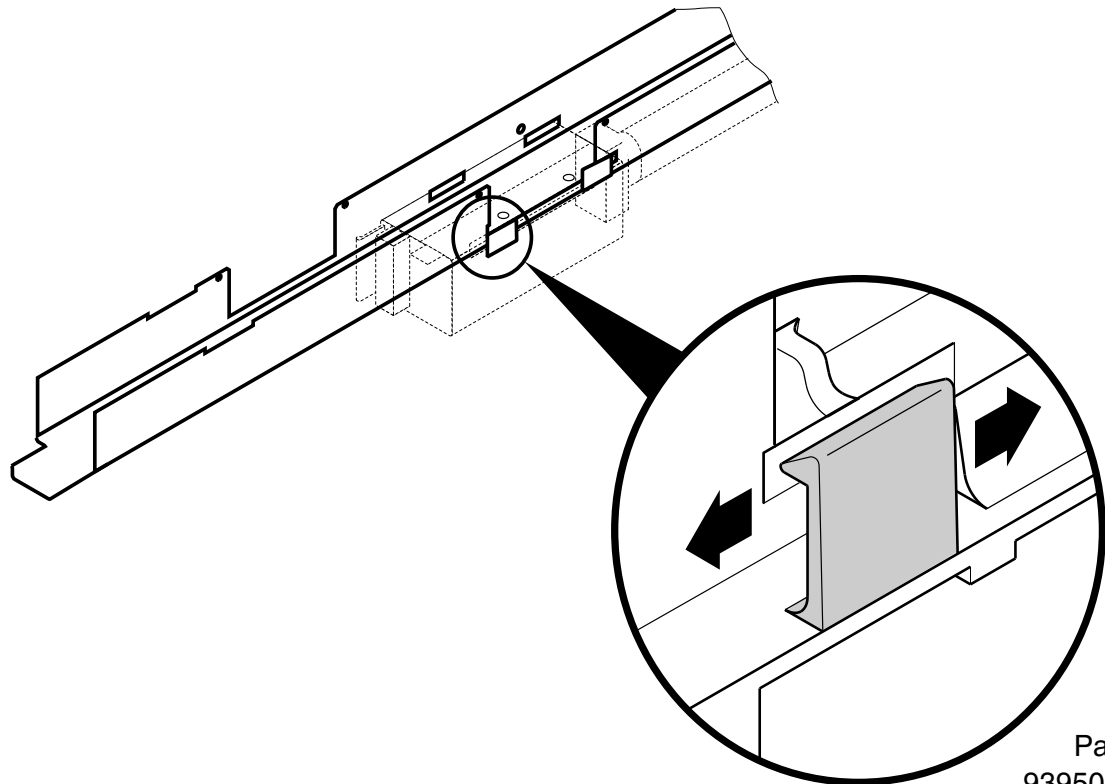
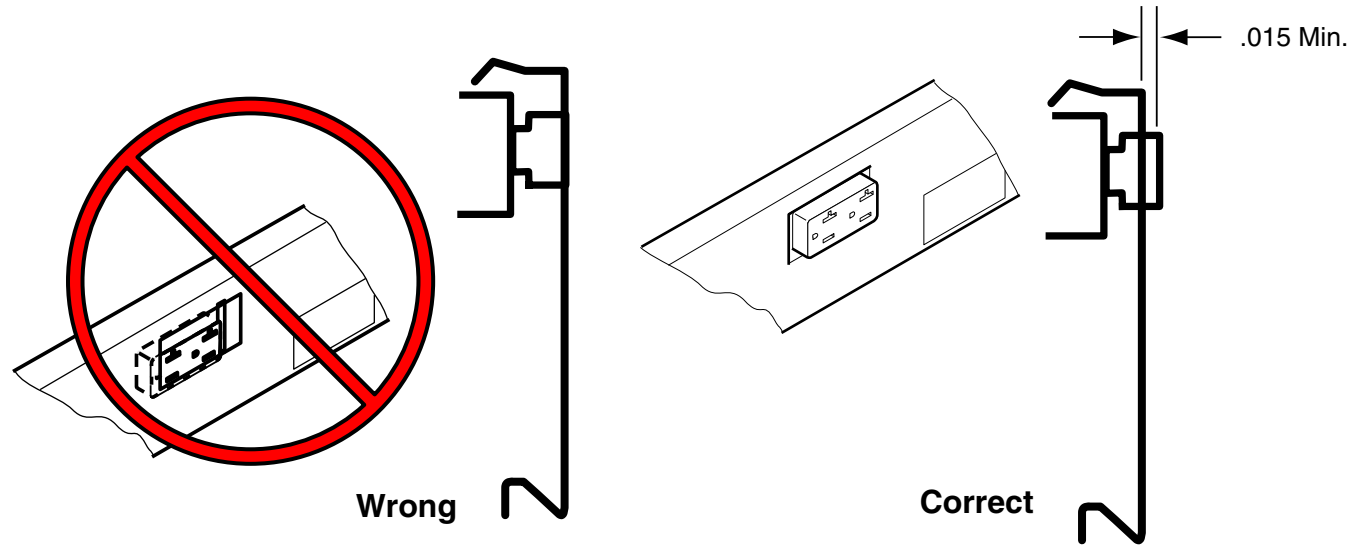

⚠ WARNING



Risk of Fire or Electric Shock

Base trim must engage in plastic retainer clips on receptacle blocks to ensure proper alignment. Receptacles should protrude from base trim when correctly installed.

6. Installation of skins normally, but not necessarily, proceed from the bottom and then upward (6a).

As the installation of skins proceed upward, each skin overlaps the lower skin and the light seal.

The alignment disc at the bottom of each fabric and steel skin should be positioned between the light seal and skin surface of the lower skin providing planar alignment (6b).

As seen in (6a), the clips on the side of the skin are positioned over the wide slots of the vertical members of a frame. When in position, the clips are pushed into the slots. The clip spring action holds the skin in place.

For 6" skins, hook the top of the skin clip into the slot below the normal clip slot & then push bottom of the clip into the top of the pair of clip slots.

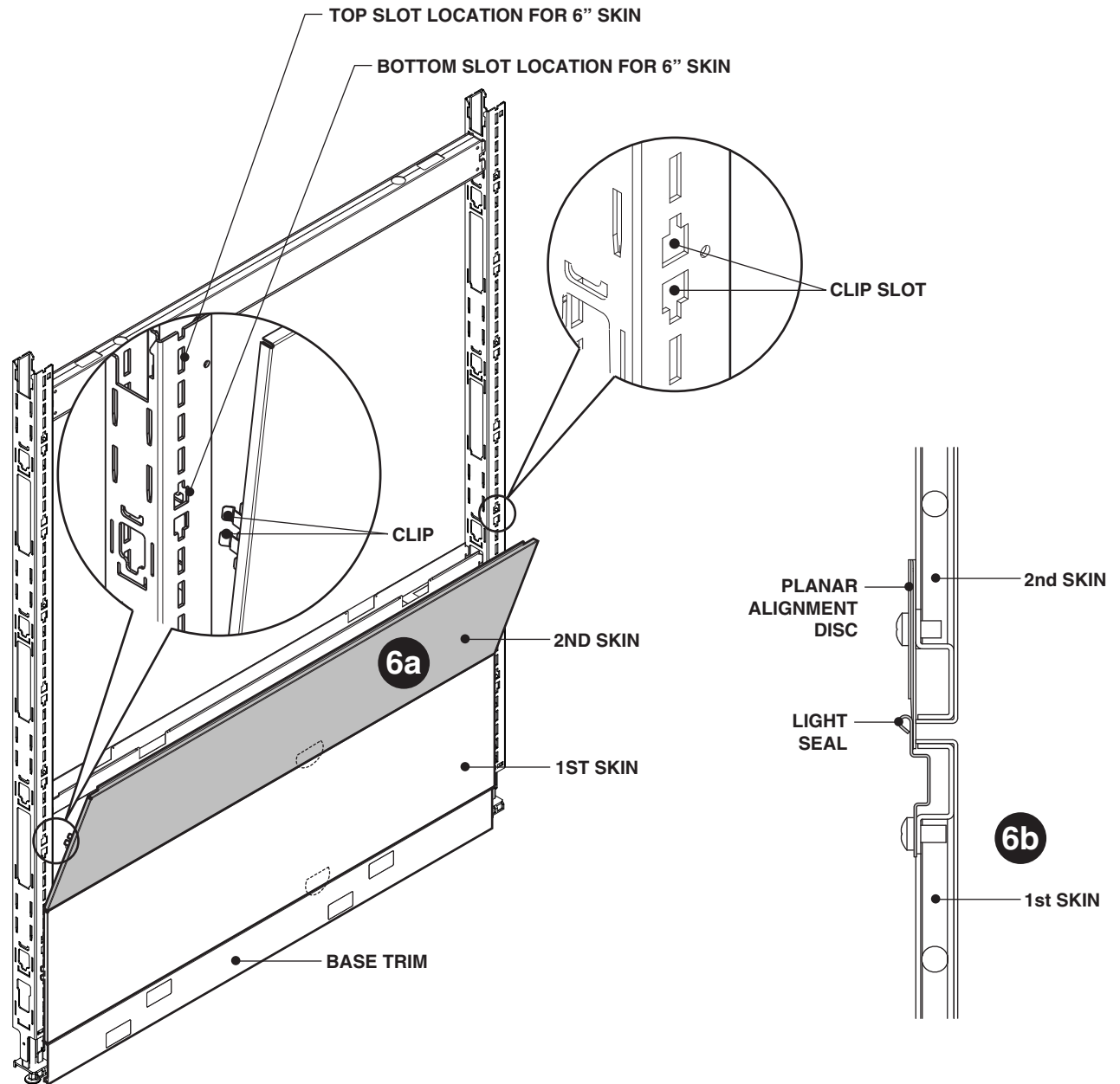

For Accessing Power in Steel Skins

1. Install the skins (1a) by aligning their attachment clips to the wider junction slots and pressing them into place (1b).

2. Place the receptacle trim bezels around the receptacles and push them into place, ratcheting them on until the bezels are behind the receptacle face and tight to the skin.

NOTE: Bezels can be removed by using a small flat-bladed screwdriver (or putty knife), prying each end of the bezel outward.

3. Apply Receptacle Fillers on any skin cutouts that do not require power termination.

4. Bezel removal (if necessary).
Pry spring clip with small putty knife or small flat-bladed screwdriver.

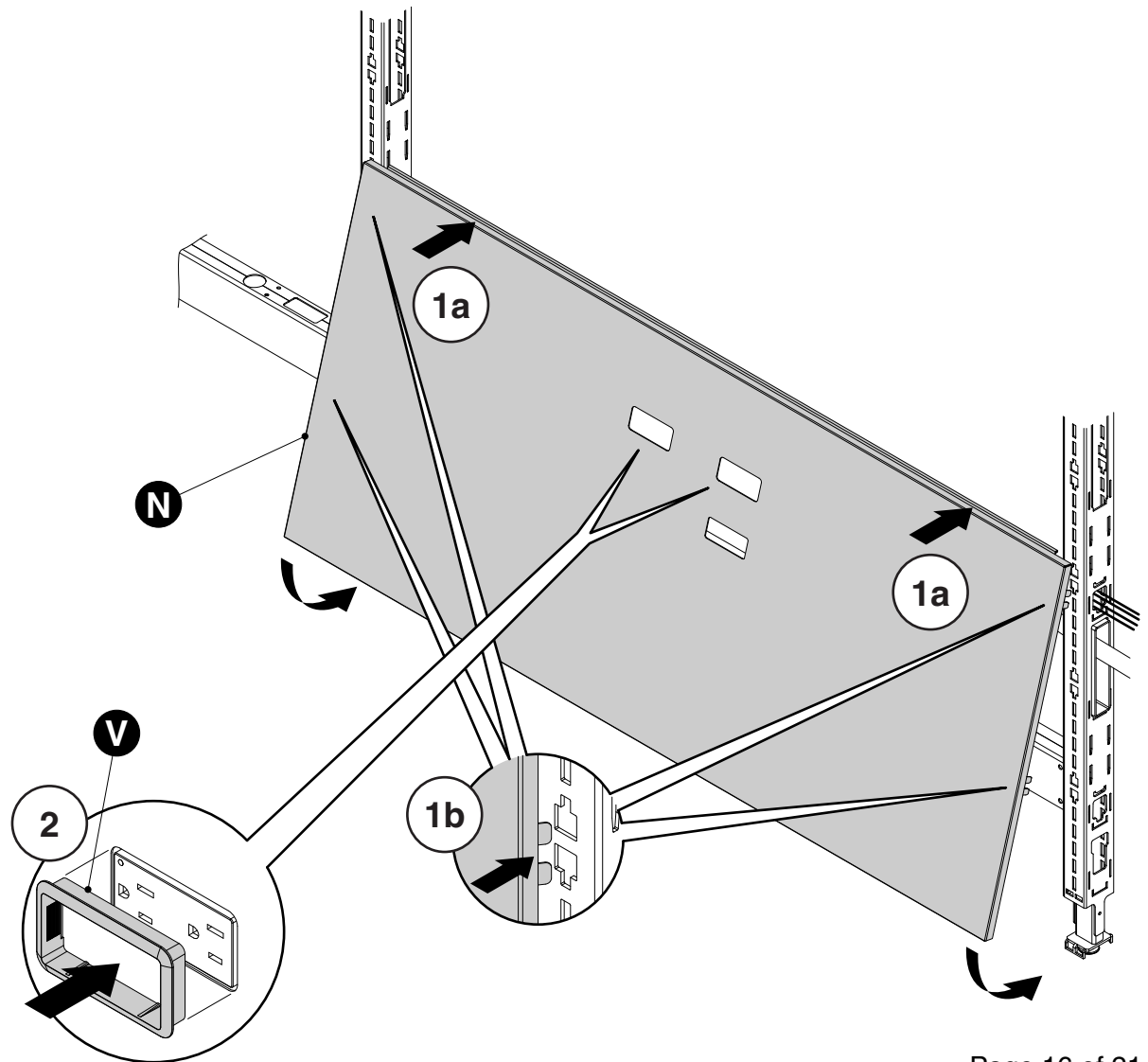
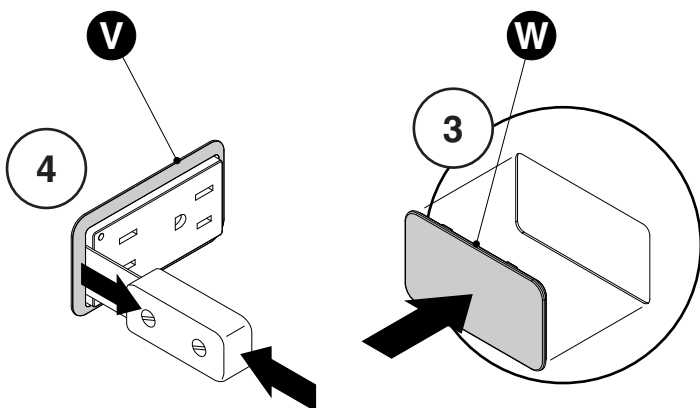

6. (continued)

It is possible to add and remove skins from a mid position where the skin above and below can remain in place as seen in (6c).

Installation is achieved by aligning the clips with the slots as previously described in (6a). After the clips have been pushed into and seated in the slots the skin bottom center will be bowed out because the alignment clip prevents the bottom of the skin from moving past the front of the skin below until the alignment clip is seated.

Seating of the clip for all conditions is achieved by placing a blade in the space between the skins and applying upward pressure while pushing on the bottom center of the skin. The clip will ride over the top of the skin below and insert into the space between the skin and the light seal.

Removal of a mid position skin is accomplished by releasing the skin clip from the vertical junction. As this is done, the alignment clip will disengage and the other skin clips will release.

For 6" skins, remove the bottom (clip) first, then pull downward to disengage the hooks.

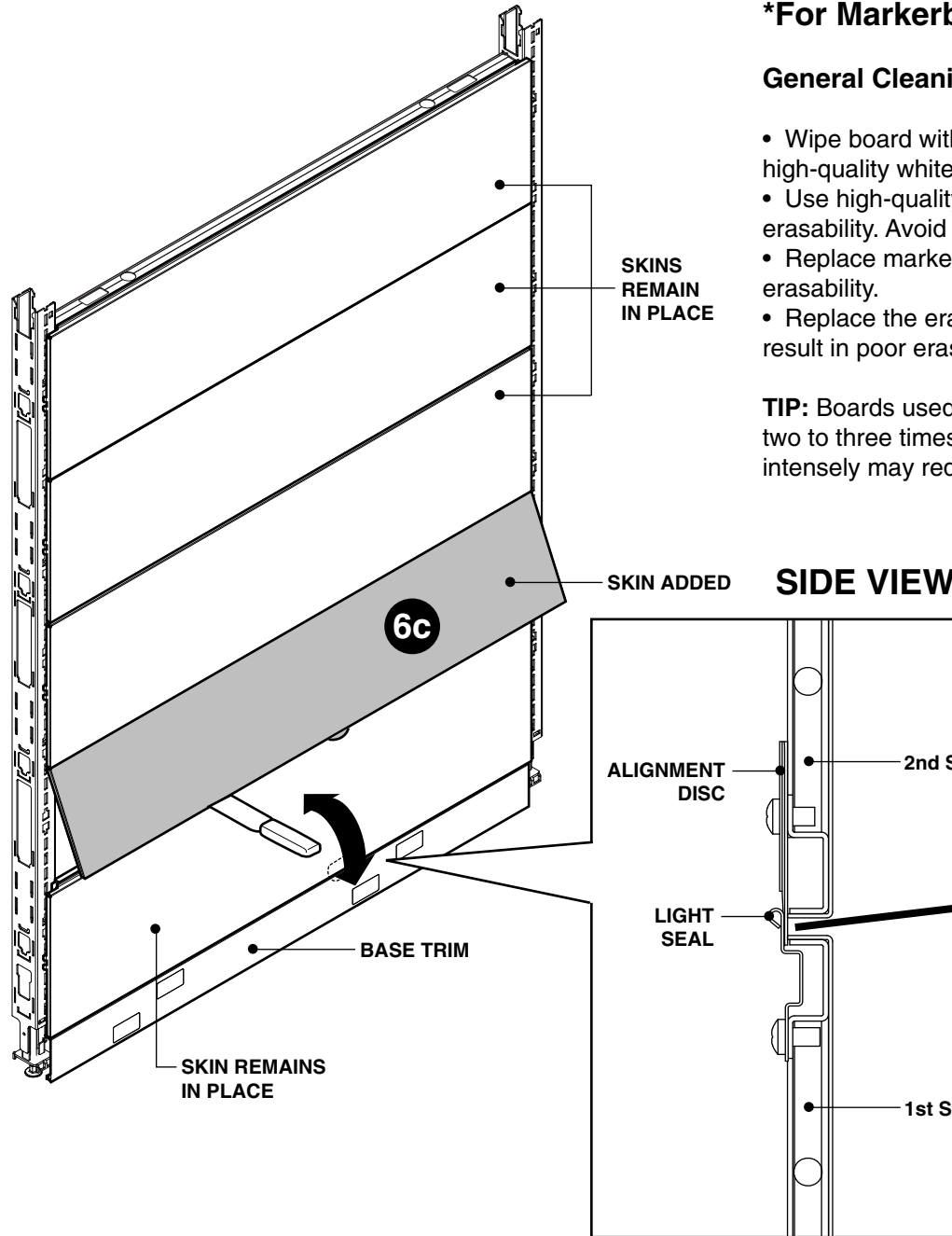

*For Markerboard Skins

General Cleaning Instructions:

- Wipe board with a clean cloth moistened with a high-quality whiteboard cleaner.
- Use high-quality dry erase markers to avoid poor erasability. Avoid low odor.
- Replace markers when almost dry to avoid poor erasability.
- Replace the eraser felt regularly. Dirty felt will result in poor erasability.

TIP: Boards used moderately should be cleaned two to three times a week. Boards used more intensely may require daily cleaning.

Phase III - Panel Trim

1. Inventory Junction Caps, Vertical Trim, Top Caps and Aligners.

Glossary of Parts

- A - Universal Junction Cap
- B - 120° Junction Cap
- C - End-of-Run Inline Change-of-Height, Slim Junction Cap
- D - Corner COH Slim
- E - Inline COH, Cable Management
- F - Corner COH, Cable Management
- G - Corner Panel Top Cap Aligner
- H - Inline Panel Top Cap Aligner
- J - Top Cap
- K - End-of-Run Junction Trim
- L - "L" Junction Trim
- M - "T" Junction Trim
- N - 120° "V" Junction Trim
- P - 120° Trim - COH
- R - End-of-Run - Top Cap Aligner
- T - 120°/"V" COH Aligner
- U - 'L'/'T' COH Aligner
- V - Junction Cap - COH

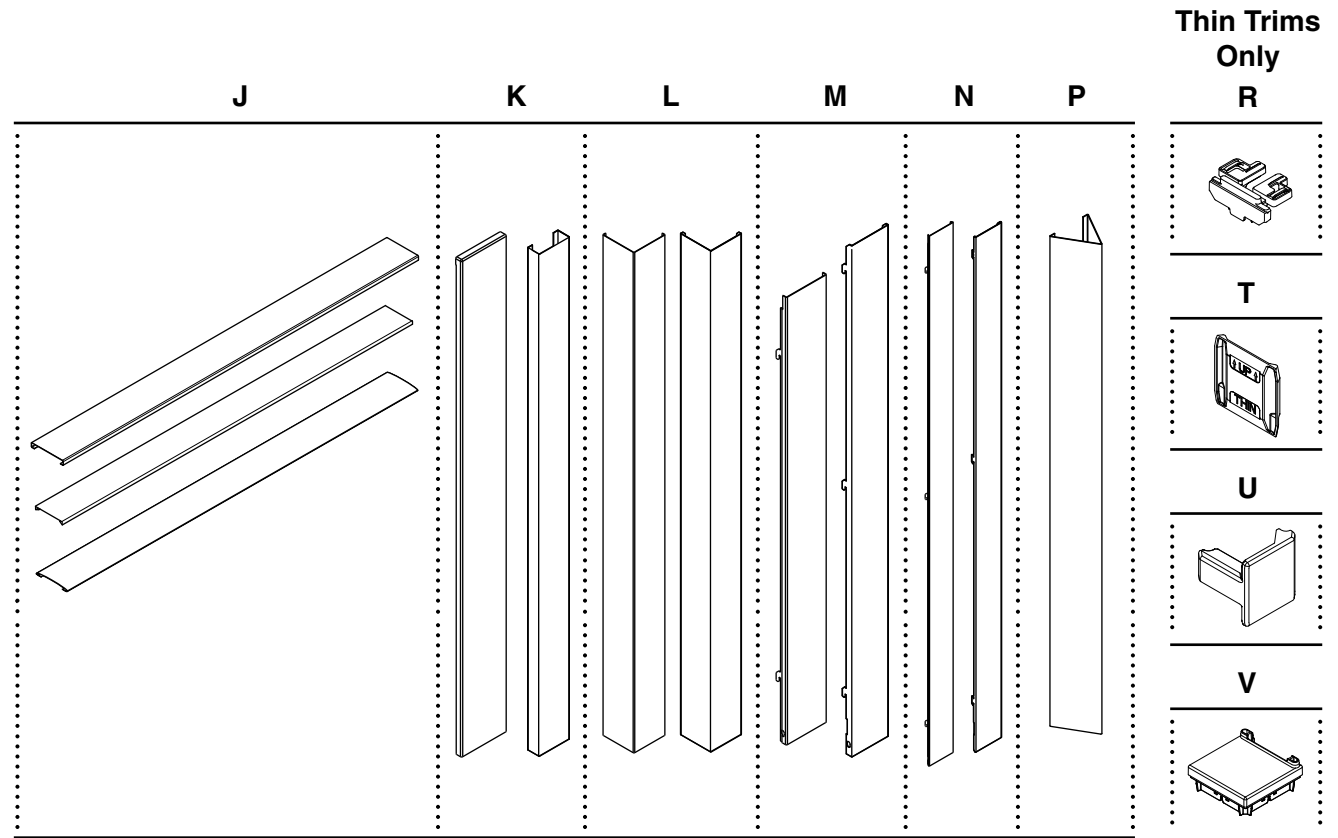
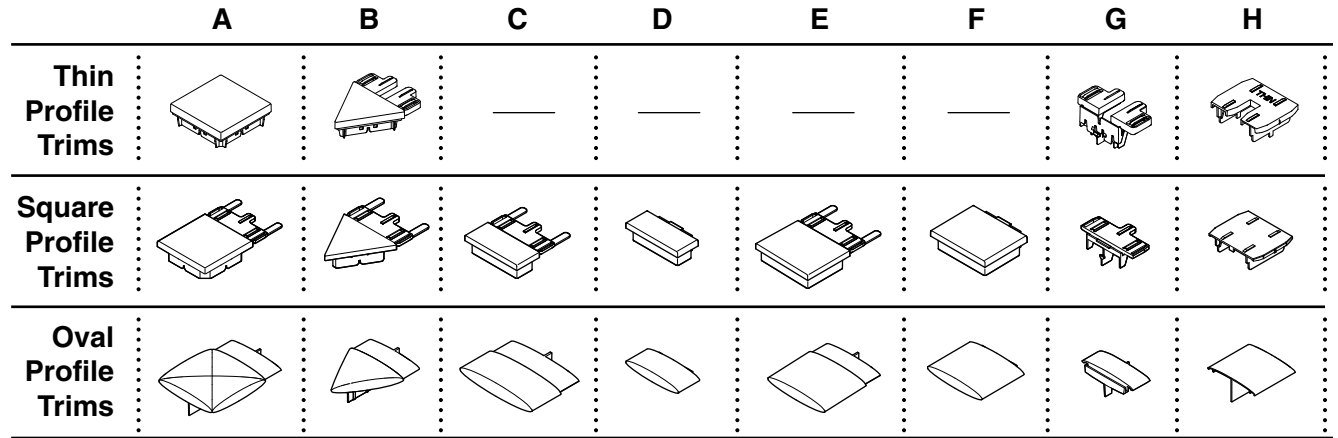

Refer to assembly instruction 939504672 for change-of-height (COH) applications.

End-of-Run Top Cap Aligner (Thin Trim Only)

2. Snap vertical trim to junction as illustrated.

△ **Tip:**
Trims assemble best when working from lowest to highest.

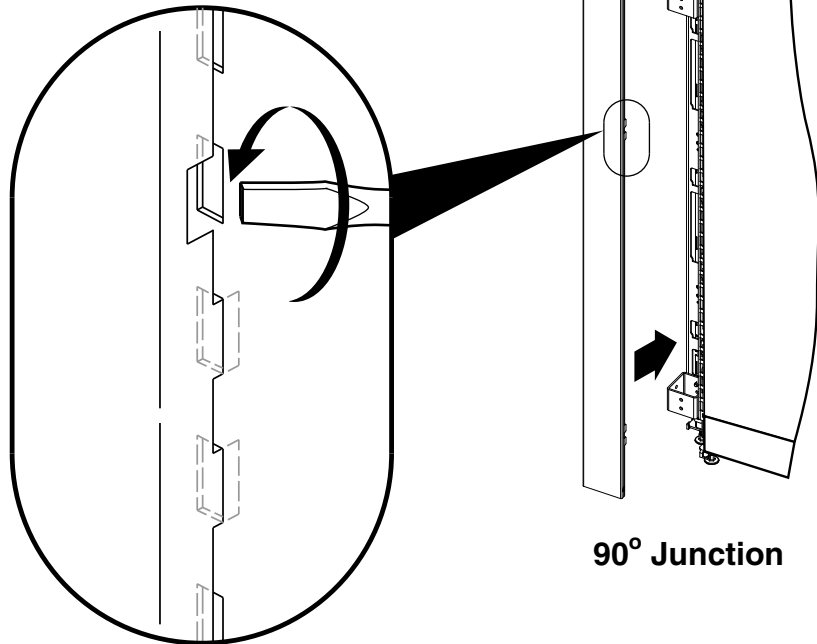

90° Junction

△ **Tip:**
Use a flat bladed screwdriver in slot to help remove "L" Trim when disassembling.

Refer to assembly instruction 939504672 for oval and square trim change-of-height (COH) applications and 939504685 for thin trim COH applications.

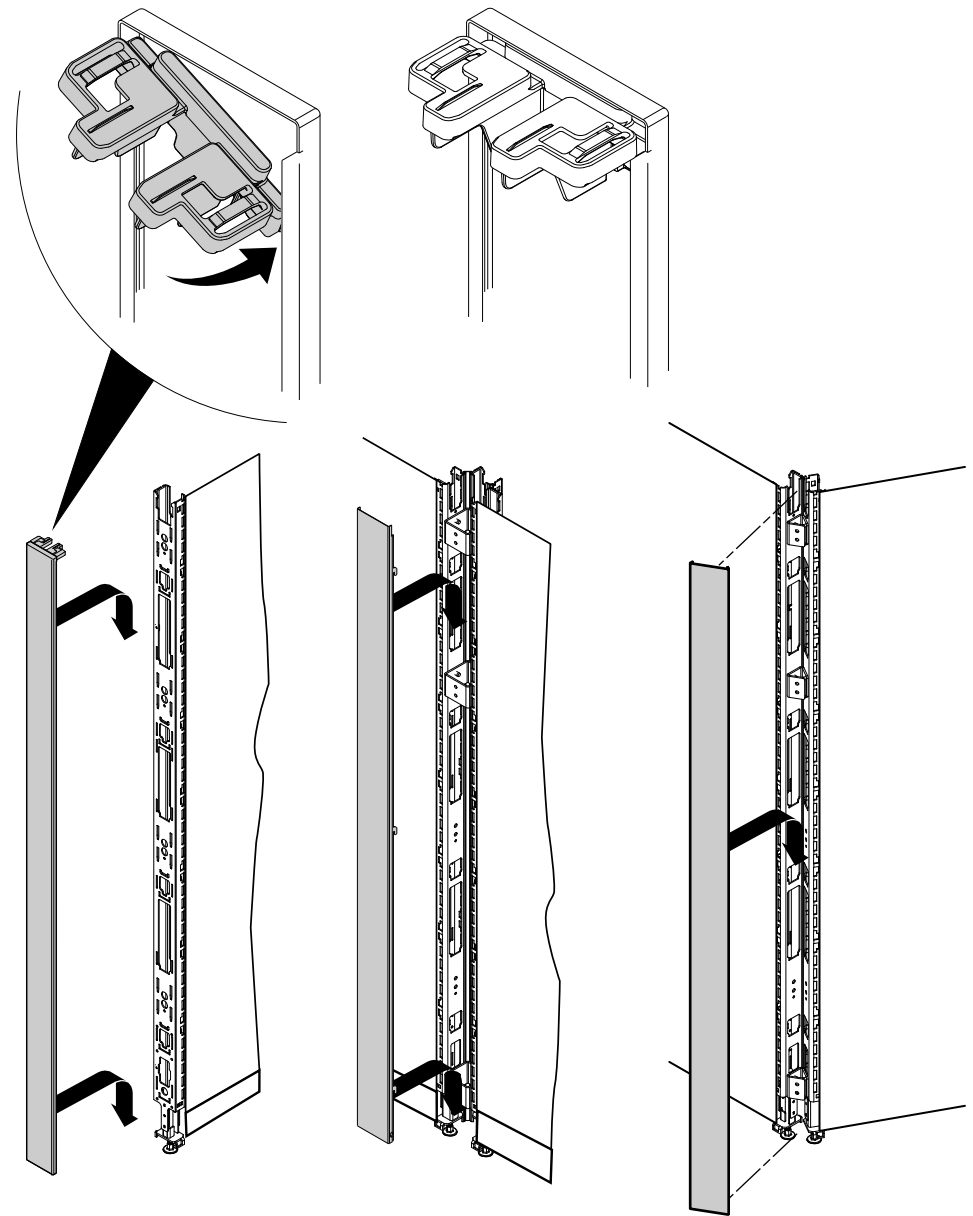

End-of-Run Junction

"T" Junction

120° "V" Junction

For Oval Profile Trims:

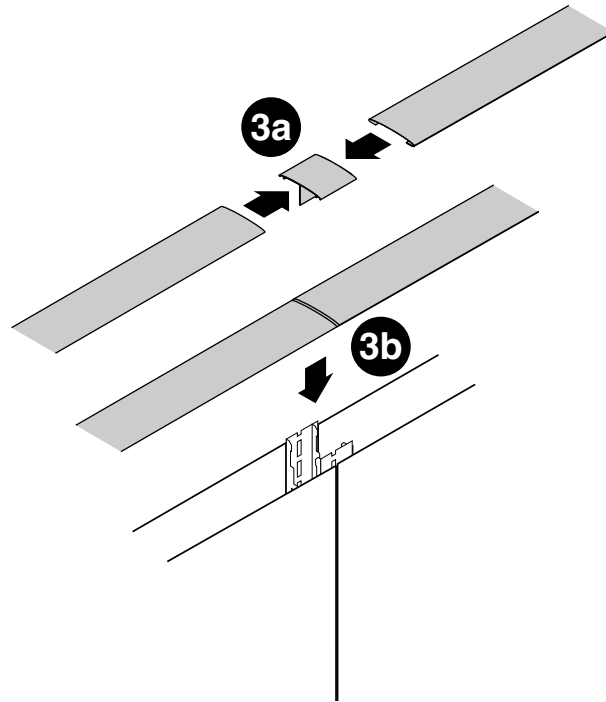

3. Lay out and assemble all top caps with their respective aligners and junction caps.

Snap all top cap assemblies into place.

4. For fabric or wood covered vertical trims, affix the painted steel cover at the base of the vertical trim as shown.

For Square and Thin Profile Trims:

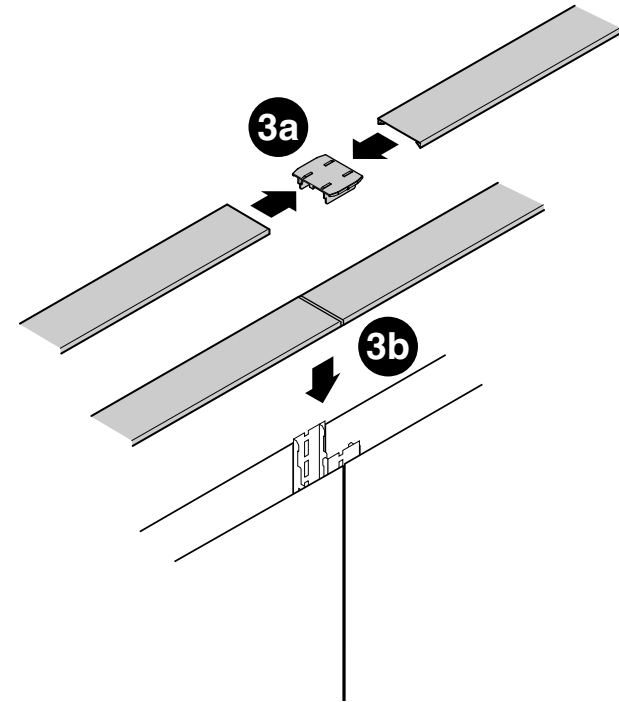

For Oval and Square Profiles Only

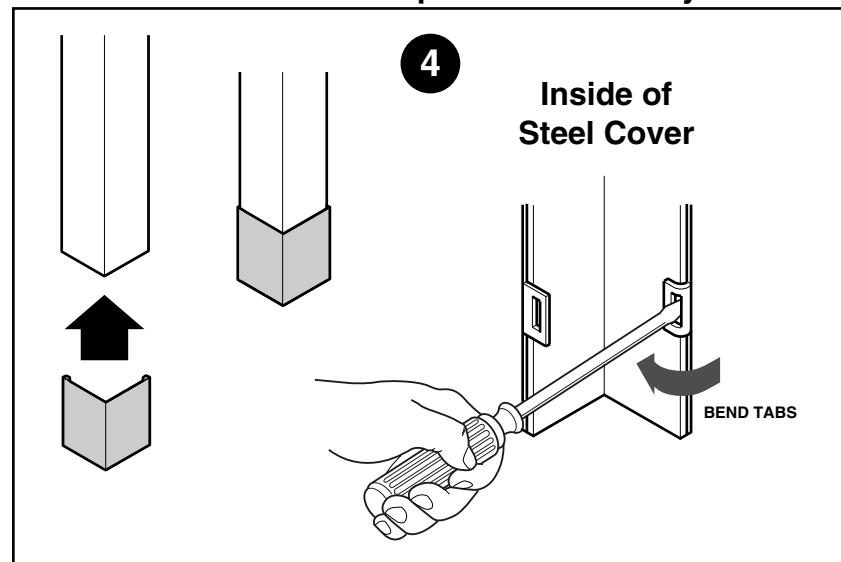

Assembly of Corner Top Cap Aligner (Square and Thin Profile)

5a. Ensure tab is in slot.

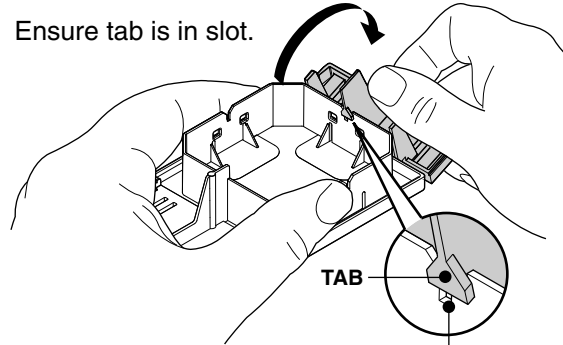

5b. Push down and together.

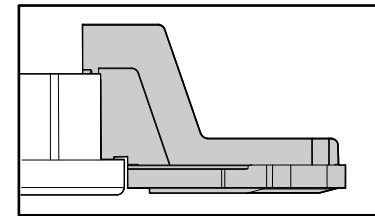
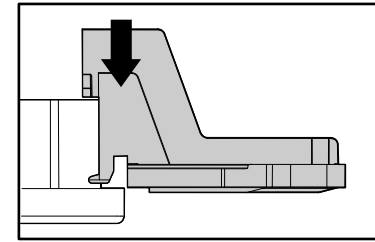
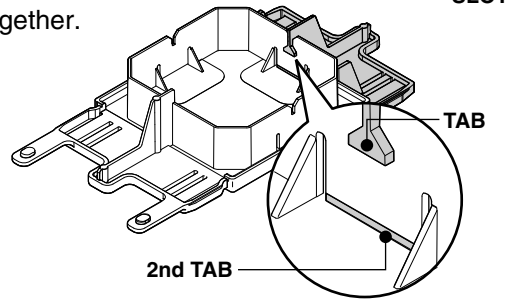

Square and Thin Profile

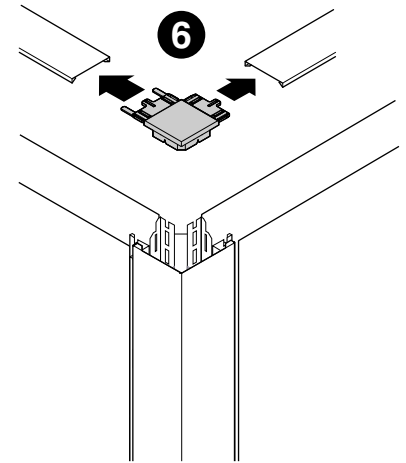

Assembly of Junction Caps

5. Assemble corner aligners and corner junction caps to universal junction caps.

6. Assemble junction caps to panel top caps.

Assembly of Corner Top Cap Aligner (Oval Profile)

5a. Align slot with edge of corner top cap.

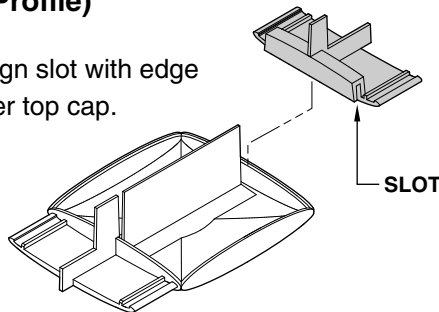

5b. Push down and together.

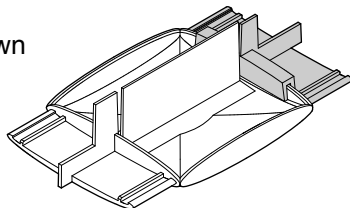

Oval Profile

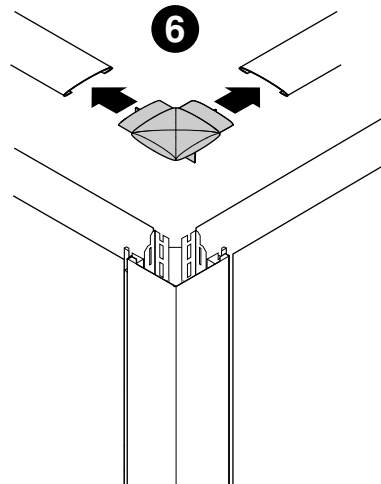

INDICATOR FOR
GATE SIDE OF PART

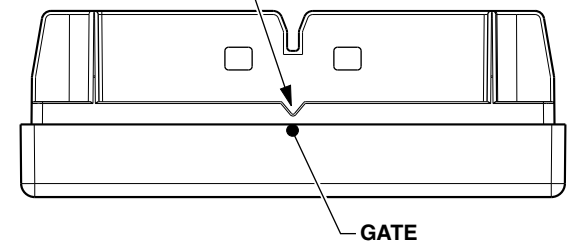

On thin profile caps, make sure first Corner Aligner is installed over **gated side** of Junction Cap.